

Plastiseal*

Rubber-bitumen cold applied joint sealant

Uses

It is used for sealing joints in flashings, guttering and sheet laps, irrigation channels, open water retaining structures and for integral part of the Proofex waterproofing system.

Advantages

- Firm flexible weather resistant seal
- Excellent slump resistance
- Excellent immersed adhesion
- Compatible with asphalt or bituminous surfaces
- Unaffected by alkalis or sulphates
- Easily gunned
- Suitable for joints up to 40 mm wide

Design criteria

Joint size: Joints should be of a size to permit adequate application of Plastiseal. Very narrow joints are difficult to seal effectively and for most applications 10 mm should be considered the minimum width. Maximum recommended width is 40 mm. A minimum seal depth of 15 mm must always be maintained. To ensure that the sealant operates within its stated movement capacity (MAF 10% in butt joints) the sealing slot widths should be designed in accordance with the recommendations of BS 6093. The use of Primer 3 is always recommended on porous surfaces.

Example of a sealed transverse joint in an irrigation canal (showing longitudinal joint incorporating special canal joint crack inducing waterstop)

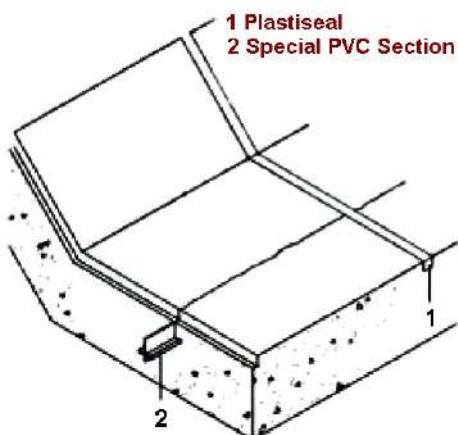

Description

Plastiseal is a flexible rubber-bitumen joint sealant with excellent slump resistance. For large projects, such as sealing joints in irrigation canals, Plastiseal can be supplied in 180 litre drums for application from the drum by a Graco, or similar, air operated pump.

Example of a sealed roof perimeter joint is shown below

- 1 Asphalt, bituminous or other roof finish
- 2 Plastiseal

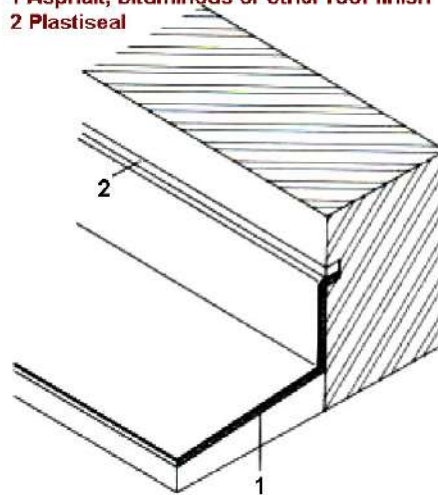

Example of a sealed joint in guttering shown below

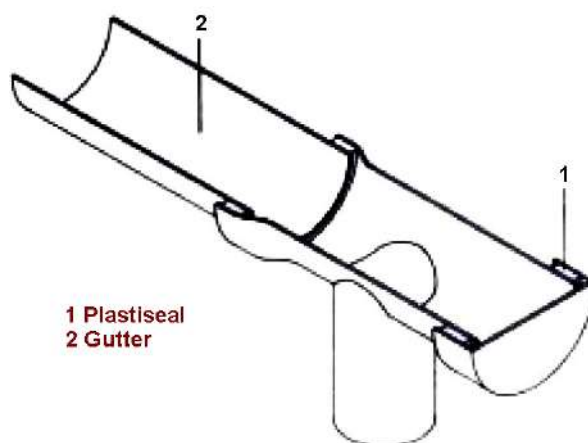

Properties

Form	: Semi-stiff paste
Colour	: Black
M.A.F (BS 6093)	: 10% for butt joints : 20% for lap joints
Setting time (Depends on conditions of exposure)	: 24 - 48 hours
Application temp.	: 5 - 50°C
Solids content	: 90% minimum
Physical or chemical change	: Solvent release
Chemical resistance to occasional spillage	
Dilute acids & Dilute alkalis	: Resistant
Solvents, Petroleum & Lubricants	: Not Resistant

Primer 3

Application temperature	: 5 - 50°C
Drying time	: 1 - 4 hour @ 25°C

Plastiseal*

Instructions for use

Joint preparation & Gun loading

Ensure that the joint surfaces are completely dry, clean and frost free. Remove all dirt, dust, laitance and loose material by rigorous wire brushing. Remove all rust, scale and protective lacquers from metal surfaces. Remove any oil or grease with Solvent 102. Cut conical tip off cartridge end thread, screw on nozzle, cut at 45° to required size and fit into sealant gun. In expansion joints, Plastiseal must always be supported by a firm backing to allow free movement. Where a particularly neat finish is required, cover face edges of joint with masking tape before priming and remove immediately after sealing work is completed.

Priming porous surfaces: Use Primer 3 on concrete, stone, brickwork, timber and unglazed edges of ceramic tiles. Allow primer to become touch dry before sealing, normally 1 to 4 hours at 25°C.

Priming non-porous surfaces: Not normally required. Ferrous metals should be treated with anti-corrosion primer

Cleaning & maintenance & storage

Clean up equipment immediately after use with Solvent 102, white spirit or paraffin. No special requirement, damage should be repaired if and when it occurs. Plastiseal will have a shelf life of 12 months when stored in dry conditions below 50°C. When stored in cold stores Primer 3 will have a shelf life of 12 months.

Limitations

Plastiseal should not be used in closed tanks or reservoirs where poor ventilation will seriously inhibit evaporation of solvent from the Plastiseal. Before permanent immersion in water, Plastiseal must be left for a minimum period of 14 days to permit evaporation of its solvent content, this is dependent upon ambient conditions & depth of Plastiseal.

Estimating

Supply

Plastiseal	: 400 ml cartridges & 25 litre pack
Primer 3	: 500 ml cans

Coverage

Primer 3	: 12.5 m ² /litre
-----------------	------------------------------



Important note

Fosroc products are guaranteed against defective materials and manufacture and are sold subject to its standard Conditions for the Supply of Goods and Service.

Fars Iran Limited

No. 9, 25 th St., Khaled Eslamboli
(Vozara) Ave., Tehran 15139 - Iran

telephone:
+98 (21) 88719021

fax:
+98 (21) 88721664

email:
iran@fosroc.com

www.fosroc.com



Cert No. THR2004006

Guide to Plastiseal quantities

These are theoretical yields without allowance for joint size variation or wastage.

Joint size (mm) w x d	Litre per metre run	Metre per 400 ml	Metre per 25 litre
10 x 15	0.15	2.60	166.60
10 x 20	0.20	2.00	125.00
15 x 15	0.23	1.80	108.70
15 x 20	0.30	1.30	83.30
20 x 15	0.30	1.30	83.30
20 x 20	0.40	1.00	62.50
20 x 25	0.50	0.80	50.00
25 x 15	0.38	1.10	65.70
25 x 20	0.50	0.80	50.00
25 x 25	0.63	0.64	39.70
30 x 25	0.75	0.53	33.30
30 x 30	0.90	0.44	27.70
35 x 25	0.88	0.46	28.40
35 x 30	1.10	0.38	22.70
40 x 25	1.00	0.40	25.00

Precautions

Health & safety & fire

Plastiseal, Primer 3 and Solvent 102 should not come in contact with the skin and eyes, or be swallowed. Ensure adequate ventilation and avoid inhalation of vapours. Wear suitable protective clothing, gloves and eye protection. Remove Plastiseal from the hands with 'Kerocleanse 22', 'Swarfega' or similar industrial hand cleanser. In case of contact with skin, rinse with plenty of clean water, then cleanse with soap and water. Do not use solvent. In case of contact with eyes, rinse immediately with plenty of clean water and seek medical advice. If swallowed seek medical attention immediately - do not induce vomiting. Plastiseal, Primer 3 and Solvent 102 are flammable. Keep away from sources of ignition. No smoking. In the event of fire extinguish with CO₂ or foam. Do not use a water jet.

Flash points

Plastiseal	: 61°C
Primer 3	: -1°C
Fosroc Solvent 102	: 33°C

* Denotes the trademark of Fosroc International Ltd.